

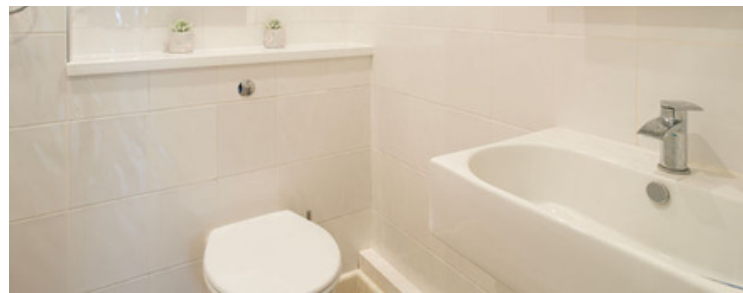

Colossus

Warleggan, Church Street,
St Mary's, TR21 0JT



Sleeps 2 | Wednesday Change over

- Double Arrangement
- Internet Access
- Outdoor patio
- Laundry Facility
- Convenient location for beaches and Quay

Colossus is a comfortable ground floor apartment close to the heart of Hugh Town and is convenient for several beaches and the coastal path.

The accommodation comprises an open-plan lounge/kitchen/diner, a bedroom with a double bed and a bathroom with a shower over the bath and heated towel rail. Fittings include a flat screen television and radio, Wi-Fi, vacuum cleaner, hairdryer, iron and ironing board.

Colossus also enjoys its own private sun deck that is accessed from the bedroom. A perfect choice for couples, Colossus is equally suited to the single traveller

Layout

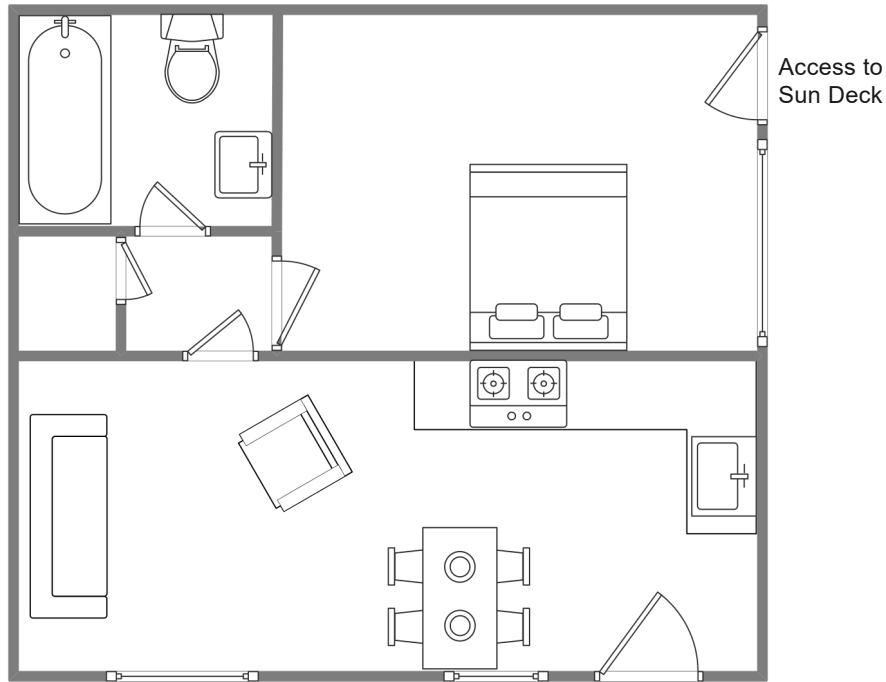

Getting to the property

Map of St Marys



Directions from the Quay | Walking time: 6-10 minutes

Head towards the entrance to the quay
Turn left at The Mermaid Inn on to Hugh Street
Keep to the left side of the road
Continue along Hugh Street to Bordeaux shop

Cross the road to the Town Hall
Walk straight ahead on to Church Street
Warleggan is about 100 yards on the right
Colossus is situated on the ground floor

What3words:///liquids.cheese.increment

Scilly Self Catering
Lower Strand
Isles of Scilly, TR21 0PS

Enquiries@scillyselfcatering.com
01720 422082
www.scillyselfcatering.com